

TECHNICAL SPECIFICATIONS

Review date: 25/06/18



SERIE: **TIME**

PRODUCT: **Female shower thermostatic with column**

CHARACTERISTICS: **Ø250 mm metallic Slim**

FINISH: **chrome**

CODE: **47 432 470 XL MT**

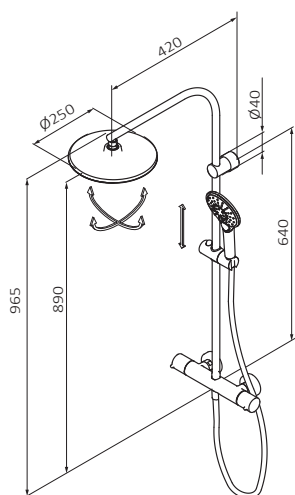

TECHNICAL SPECIFICATIONS:

- › Recommended pressure: **1 to 5 bar**
- › Maximum pressure of use: **10 bar**
- › Connexion dimensions according to **UNE EN-817**
- › Flow **3 bar min 12 l/min**

MATERIAL SPECIFICATIONS:

- › **Brass made**
- › **Metallic handle**
- › Niquel-chrome finish tested in salt spray according to **UNE-19703 and UNE-19709**
- › Acustics according to **UNE-EN 817**

USE SPECIFICATIONS:

- › GRB Live Technology, Constant temperature. Valid for all hot water supplies
- › Without minimum pressure and without calibration
- › Anti-liming and self-calibrated metallic cartridge, certificated by Aenor
- › Stop safety button 38°C
- › Column with full use of height (75 mm only from the showerhead and the ceiling)
- › Diverter and flow control on handle
- › Adjustable support
- › Rociador orientable Slim Ø250 mm metálico
- › 3F Snow hand-shower and Silver shower hose 170 cm